

Stair climber models overview



For wheelchair mounting		✓		✓	
With integrated seat unit	✓		✓		✓
IQ-function / programmable		✓	✓	✓	✓
ErgoBalance handles		✓	✓	✓	✓
Enhanced comfort display		✓	✓	✓	✓
2 pair of wheels for perfect handling on the stairs		✓	✓	✓	✓
Removable battery pack		✓	✓	✓	✓
Max. height of step	20 cm/8 inch	20 cm/8 inch	20 cm/8 inch	25 cm/10 inch	25 cm/10 inch
Min. depth of step	14 cm/5.5 inch	11 cm/4 inch	11 cm/4 inch	13 cm/5 inch	13 cm/5 inch
Max. climbing speed (stairs per minute)	12	6 – 19	6 – 19	6 – 19	6 – 19
Max. user weight	120 kg/260 lbs	140 kg/300 lbs	140 kg/300 lbs	140 kg/300 lbs	140 kg/300 lbs
Max. allowed total weight	160 kg/350 lbs	180 kg/390 lbs	180 kg/390 lbs	180 kg/390 lbs	180 kg/390 lbs

scalamobil®

Mobile stairclimbing aid

scalacombi®

Mobile stairclimber with integrated seat unit



Product advantages	49
Product setup	50
Scope of delivery	51
Accessories	52
scalacombi S36	54
scalachair X3	55
scalaport X7	57
Technical data	58



MADE IN GERMANY 

Climbing stairs the easy way.



Product advantages

The scalamobil is the cornerstone of Alber's mobility concept. It can safely handle stairs of all kinds, with very little effort.

The most important product advantages at a glance Safety and comfort for the wheelchair user and the attendant

- The scalamobil works even on very narrow and spiral staircases, regardless of the material, up to a step height of 20 cm / 8 inch (optional 25 cm / 10 inch). The stairs are optimally protected thanks to the patented climbing mechanism. Safe operation with less effort due to the new ErgoBalance handles and the ability to individually adjust the width and height of the handlebars
- Compatible with most wheelchair models thanks to special brackets
- Can be adapted onto the wheelchair in a matter of seconds without any tools being required
- Dismantles quickly into three handy parts for ease of transport
- IQ feature with safety sensors: individual programming to match the stair geometry, wheelchair and weight of the wheelchair user
- Patented Softstep feature for smooth stair climbing through the electronic control of the climbing speed as a function of the step height and hold angle

Wheelchair mounting

- Standard wheelchairs
- Active and lightweight wheelchairs
- Comfort and multi-function wheelchairs
- Hemiplegic wheelchairs
- Paediatric wheelchairs
- Carry chairs for wheelchair taxis and ambulance services

Stub axles are a prerequisite for the use of a scalamobil. Alber can convert wheelchairs that do not have stub axles at their premises.

Some wheelchair manufacturers can supply special frames with an integrated bracket for the scalamobil. Our Customer Service team would be delighted to assist you should you have questions regarding the compatibility of a wheelchair with the scalamobil.

Our quality promise – Your safety

Seal of approval and testing institute		TÜV Süd, Hanover
CE conformity		Complies with the EU Medical Devices Directive 93/42/EWG
as per application class	<input type="checkbox"/> Class A (Indoors)	<input checked="" type="checkbox"/> Class B (Indoors and outdoors)
		<input type="checkbox"/> Class C (outdoors)
Other tests		Fitness for purpose study by the Stiftung Vollmarstein
Awards	reddot design award winner 2011	bundespreis produkt design 2000/2001

How it works:



Move the scalamobil to the step ...

... climb up or down the step ...

... approach the next step.

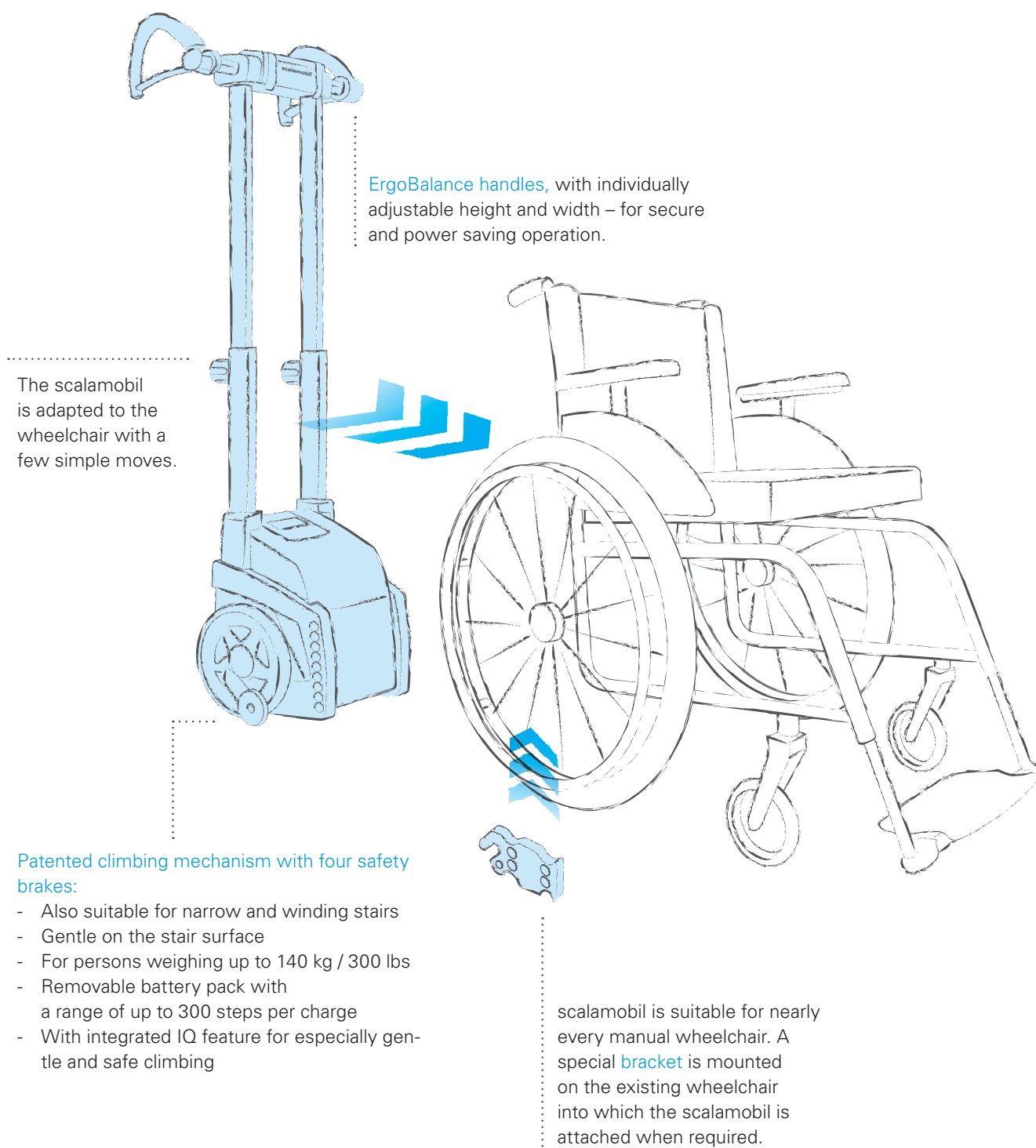



Handlebar

- ErgoBalance handles developed by specialists for secure hold and minimal operating force. With soft padding at especially strained pressure points
- Separate control elements to pre-select the climbing direction and to start climbing action
- Ergonomically designed operating switch: eliminates fatigue, ideally suited even for longer use
- SoftTouch comfort pad at the rear of the control unit allows the operator to support the climbing operation when coming downstairs using his/her upper legs
- The width of the left and right handle are separately adjustable to accommodate narrow stairwells or the build of the attendant
- Stepless height adjustment of the handlebar
- Handlebar can be easily connected to and removed from the drive, without cables



LCD

- Well arranged display with clear indication of the climbing direction and warning signal for low battery
- Sensor field for drive away lock
- On/Off switch with backlight



E-box with control elements

- Interface to program and configure the IQ function
- Switch to activate/deactivate single step mode
- Stepless selection of climbing speed from 6 – 19 steps/min



Climbing unit with automatic safety brakes

- Patented climbing mechanism, designed for use on virtually any stairs
- Tyres made from non-abrasive material protect the stair covering reliably
- Four automatic safety brakes with improved obstacle negotiation stop the scalamobil reliably before the edge of each step
- Housing made from sturdy yet lightweight aluminium
- Practical carrying handle for easy loading
- With bolts for holding the wheelchair



Battery pack

- One charge is sufficient for up to 300 steps (for a person weighing approx. 70 kg / 150 lbs)
- Can be easily replaced to extend the range
- The battery can also be charged when separated from the scalamobil



Automatic battery-charger

- Electronic charging and switch-off mechanism
- Visual charge indicator
- Automatic adaptation to the mains voltage 90 – 240 Volt (convenient during travel)



Scalamobil S38 with climbing height extension

- For steps up to 25 cm / 10 inch
- Also available with the universal adapter scalaport X7
- The combination with scalachair X3 requires a modified frame



scalamobil fly S39

- scalamobil S38 with integrated seat unit
- For steps up to 25 cm / 10 inch
- Also available with a comfortable chest shoulder belt



Bracket

- For fixing the scalamobil to the wheelchair, (please include in order, if not present)
- Please indicate wheelchair type and seat width



Conversion from screw to stub axles

- A quick release system is required as the large wheels of the wheelchair must be removed for climbing stairs
- Conversion consists of hubs, spokes, stub axles, adapter sleeves, mounting
- Available for normal standard hubs and drum brakes



Special bracket system for pediatric wheelchairs

- For the attachment of paediatric wheelchairs from seat width 28 cm / 11 inch
- For attachment of narrow wheelchairs for adults with seat width < 40 cm / 16 inch (on request)
- Max. user weight: 60 kg / 130 lbs
- Alternately, the scalaport X7 can also be used for the transport of narrow wheelchairs from a seat width of 26 cm / 10 inch



Tilt assist

- Facilitates the tilting of the wheelchair when driving over obstacles (not compatible with scalachair X3)
- Mounted on the wheelchair bracket for the scalamobil (must be removed in order to climb stairs)
- Can only be used after removal of the scalamobil (cannot be used in combination)



Safety lap belt

- With tried-and-tested quick-release safety buckle
- 90 cm / 35 inches long
- Easy fitting to the wheelchair
- Also available with an automatic belt



Anti-tippers

- Removable via quick-release mechanism
- Adjustable in height and length
- With automatic swivelling function for crossing curbs and thresholds
- Are secured to the wheelchair bracket for the scalamobil (must be removed in order to climb stairs)



Headrest

- Ensures optimum support and stability of the neck and head area during stair climbing
- With clip function for scalamobil and scalacombi
- With soft padding
- Adjustable height, depth and angle of incline



Wheel transport bracket

- To transport the wheelchair wheels with the scalamobil
- Wheels do not need to be transported separately
- Bracket is compatible with all conventional wheelchair models



In-vehicle charger

- To charge the battery pack in the vehicle while driving
- Electronic charging and switch-off mechanism (function dependent on vehicle used)
- Visual charge indicator
- Voltage range of 12 V– 32 V



Product advantages

- With integrated seat unit, e.g. for people who do not necessarily need a wheelchair
- Ideal for narrow stairwells and in areas where space is restricted, e.g. when a wheelchair is too big
- Attractively designed seat and backrest with soft padding
- Steerable castor wheels with parking brakes
- Swivelling armrest for easy access by user
- The seat and footrest fold up easily making them extremely compact for storage
- Dismantles easily within seconds for ease of transport
- Also available as a climbing height extension for step heights of up to 25 cm/10 inch (scalamobil fly)
- Also available with a comfortable chest shoulder belt



CE compliant in accordance with the Medical Products Directive

Technical data scalacombi S36 (scalamobil fly S39)

(A) Total length, rear wheel to end of footrest	73 cm (29 inch) 76 cm (30 inch)
(B) Length, rear wheel to front edge of seat	63 cm/25 inch
(C) Widest point (armrest)	50 cm/20 inch
(D) Seat width	37 cm/14.5 inch
(E) Seat depth	47 cm/18.5 inch
(F) Seat height, floor to bottom edge rear	50 cm/20 inch
(G) Seat height, floor to bottom edge front	52 cm/20 inch
(H) Ground clearance, footrest	3 cm/1 inch
Total weight	37,5 kg/8 lbs
Weight, seat unit	12,5 kg/3 lbs
Max. weight of the person	140 kg/300 lbs*
Max. permissible total weight	180 kg/390 lbs*

* For details on the maximum weight of the person, see also notes on weight specifications



Folds down to save space



Disassembled for transport

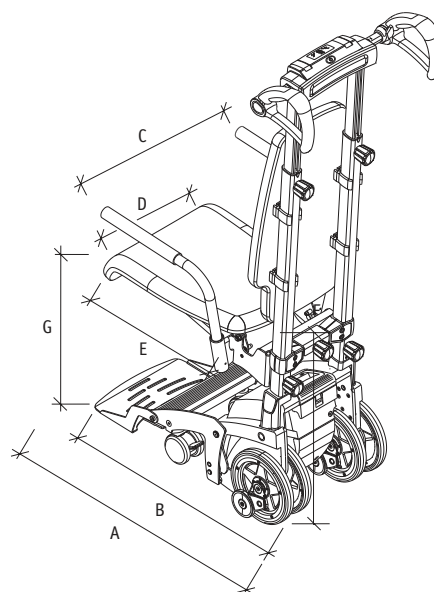

Product advantages

- Comfortable push wheelchair ideally matched to the scalamobil
- Integrated bracket for the scalamobil
- Highly manoeuvrable and highly functional thanks to the small dimensions
- Can be used in the home and around the house
- Seat shells can be mounted easily

Function

- The cushions are removable, washable and comfortable to sit on
- The easy-rolling wheels with integrated brakes make the chair comfortable to push and provide a secure footing to shift to another chair
- The scalachair X3 can be folded down easily so that it takes up less space when being transported or stored (folding version is available as an option)
- To guarantee a secure hold and optimum comfort when climbing stairs, the backrest extends up to the shoulder area
- The footrest can be folded up so that the user can use the tips of their toes to move along
- The integrated bracket with auto-centring ensures safe and fast docking of the scalamobil
- The armrest can be folded up out of the way to facilitate access to the chair

i When combined with the S38, a frame modification is required.



scalachair X3
(available as both a folding and a rigid version)

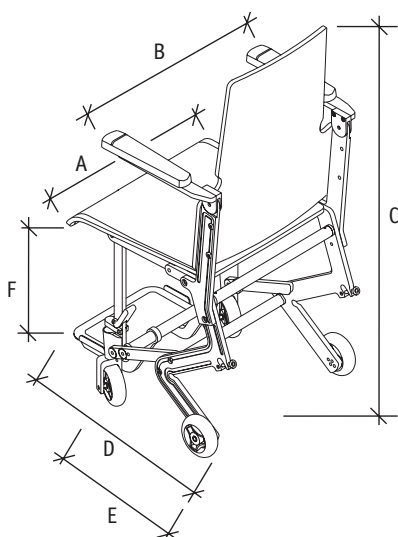

Technical data

(A) Seat width	41 cm/16 inch
(B) Total width	51 cm/20 inch
(C) Total height	95 cm/37 inch
(D) Depth with footrest	65 cm/25.5 inch
(E) Depth without footrest	42 cm/16.5 inch
Depth with scalamobil	80 cm/31.5 inch
(F) Seat height	45 cm/18 inch
Weight	12,8 kg/28 lbs
Max. weight of the person	107 kg/300 lbs

* For details on the maximum weight of the person, see also notes on weight specifications



Harness belt system

- with foot strap for scalachair X3



Push handles

- for scalachair X3
- Adjustable height



Headrest

- for scalachair X3
- Adjustable height and depth



Foot belt

- for scalachair X3



Lap belt

- for scalachair X3

Product advantages

- Any manual wheelchair is ready to be transported in just a few seconds
- Docks with wheelchair without the need for a bracket or conversion
- Suitable for all conventional wheelchairs. Also suitable for paediatric wheelchairs from seat width 26 cm/10 inch
- Ideal for medical transport services and public buildings
- The new folding mechanism makes it extremely compact for transport



Attaches simply to the backrest



scalamobil S35 IQ with scalaport X7



Folding mechanism enables space-saving transport (only in combination with scalamobil S35)



Adjusts quickly to the wheelchair width

Dimensions	Minimum	Maximum
(1) Track width of the wheelchair wheels	39 cm/15.3 inch inside measurement	73 cm/28.7 inch outside measurement
(2) Seat height, wheelchair rear	approx. 35 cm/14 inch from the ground	-
(3) Height, wheelchair frame	14 cm/5.5 inch from the ground	-
(4) Width, backrest	35 cm/13.8 inch* *with adapter: 25 cm/10 inch	55 cm/21.6 inch* *with adapter: 40 cm/15.7 inch
Weight, scalaport without scalamobil	11 kg/24 lbs	-
System weight	35.5 kg/78 lbs	-
Max. weight of the person	-	120 kg/264 lbs *
Max. total weight	-	160 kg/352 lbs *

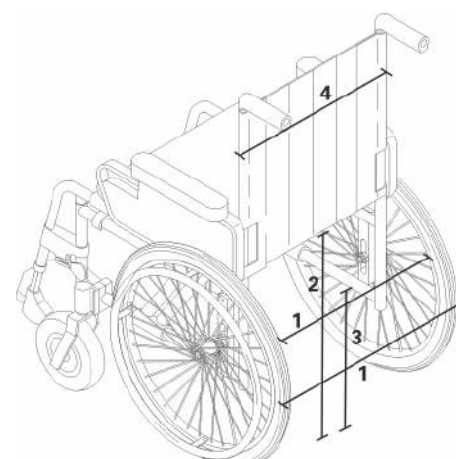

* For details on the maximum weight of the person, see also Notes on weight specifications



Battery pack

S35, S36, S38, S39	Range of battery cells	2x12 V; 3.4 Ah; leak-proof and maintenance-free, range up to 300 steps (approx. 20 floors depending on the wheelchair user and the wheelchair)
-----------------------	------------------------	--

Climbing unit

 Max. weight of the person	scalamobil: 140 kg*/300 lbs* scalacombi: 140 kg*/300 lbs* scalamobil mit X7: 120 kg*/260 lbs* scalamobil mit X3: 107 kg*/235 lbs*
Max. total weight	180 kg*/390 lbs*
Step height	max. 20 cm/8 inch S38/S39 with climbing height extension up to 25 cm/10 inch
Step depth	min. 11 cm/4 inch (13 cm/5 inch for S38)
Motor rating	176 Watt
Climbing speed	6–19 steps/min
Battery charging time	24 V

Charger

Input voltage	90–240 V (AC), 50–60 Hz; automatic adaptation to the mains voltage
Output voltage	24 V (DC)
Charge current	1.0 A
Battery charging time	approx. 3.5 h

Weight

Total weight	25.5 kg/56 lbs (S36: 37.5 kg/82 lbs)
Climbing unit with battery	20.6 kg/45 lbs
Climbing unit without battery	17.9 kg/39 lbs
Battery pack	2.7 kg/6 lbs
Handlebar	4.9 kg/11 lbs

Depending on the suitability of the attendant and the wheelchair used.
See also section entitled Notes on weight specifications



CE compliant in accordance
with the Medical Products Directive

